

DECK SLAB: ONE COURSE CONSTRUCTION REINFORCEMENT DETAILS

ISSUED: 2009

PLATE
3.6-1

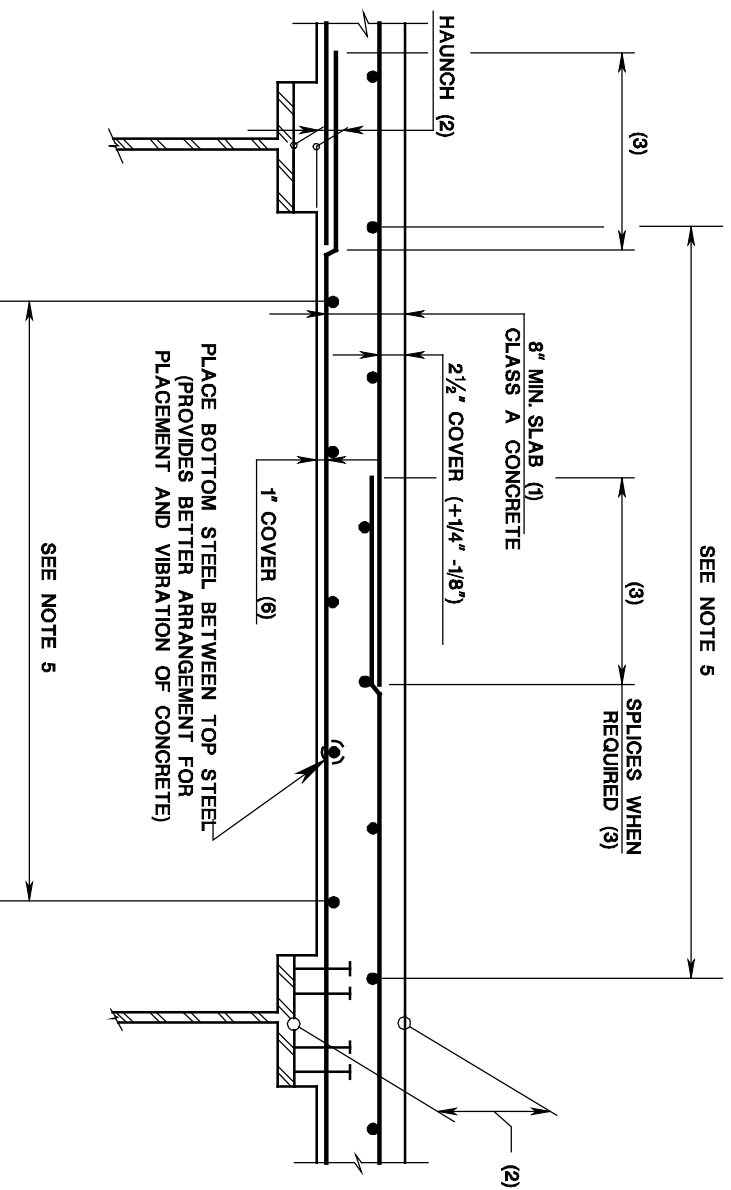

TYPICAL SLAB SECTION

NOTES:

1. SEE SUBSECTION 20.6 OF THIS MANUAL.
2. SEE SUBSECTION 20.8 OF THIS MANUAL.
3. THE SPLICES IN BOTTOM TRANSVERSE BARS SHALL BE ALTERNATED OVER ADJACENT BEAMS. THE SPLICES IN TOP TRANSVERSE BARS SHALL ALTERNATE OVER THE CENTERS OF ADJACENT BEAMS.
4. ALL REINFORCING STEEL SHALL BE CORROSION PROTECTED.
5. FOR DECK SLABS THAT MEET THE DESIGN CRITERIA OF APPENDIX A4 OF THE AASHTO LRFD SPECIFICATIONS, THE TOP AND BOTTOM LONGITUDINAL REINFORCEMENT SHALL BE AS PER THE TABLE OF SUBSECTION 20.5 OF THIS MANUAL. OTHERWISE, THE REINFORCEMENT SHALL BE DESIGNED ACCORDING TO AASHTO LRFD MINIMUM SPACING REQUIREMENTS.
6. PROVIDE 1½" BOTTOM COVER IN BRIDGE STRUCTURES THAT ARE LOCATED IN A MARINE ENVIRONMENT.